

Round 50W LED Chip High Power Driverless Full Spectrum AC220V

Basic Information

- Place of Origin: Shenzhen China
- Brand Name: newspectrum
- Model Number: NEW 7660
- Minimum Order Quantity: 100pcs
- Price: Negotiable
- Packaging Details: Antistatic bag, boxes in carton.
- Delivery Time: 3-8 work days
- Payment Terms: L/C, D/A, D/P, T/T, Western Union, MoneyGram
- Supply Ability: 100000pcs/day

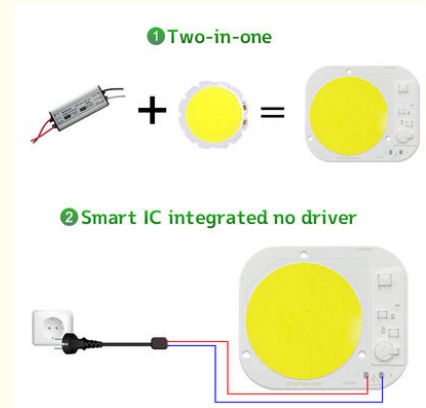

Product Specification

- Product Name: 50W LED Chip
- Voltage: AC220-240V
- Power: 50W
- Luminous Flux: 100lm/w
- Board Size: 74mm*85mm
- Highlight: Round 50W LED Chip, Driverless 50W LED Chip, AC220V High Power LED Chip



More Images

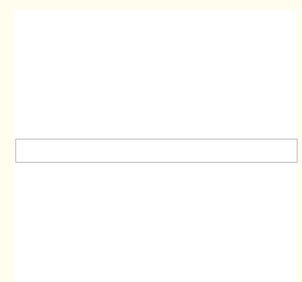
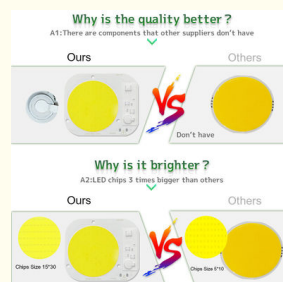
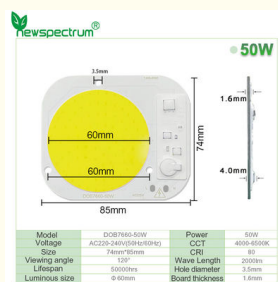

Product Description

AC220V 50W Driverless COB LED Round Light Chip Full Spectrum 380nm-840nm for Indoor Seedling Hydroponic Plant Grow Lamp

LED Chip COB Driveless 50W AC 220V Round Φ 60mm Flip Lamp Beads Driverless Smart IC Bulb For DIY Floodlight Spotlight

Specifications

Voltage	AC220-240V(50HZ/60Hz)
Power	50W
Luminous Flux	100lm/w
CRI(Ra)	80
Luminous Diameter	Φ 60mm
Board Size	74*85mm
Working Temperatur	-20°C~60°C
Application	Spotlights/Grow light/Flood light
Customized	Please contact us

Why Choose Newspectrum?

We are a manufacturer, focusing on AC COB 12 years
High quality control standards, quality assurance
over 12 years OEM + ODM experience
Custom products based on customers' needs
Reliable, consistent and timely service
Voltage-regulator for ic vdd protectio
Driver IC, over voltage and over current control
NTC sensor for pcb overheat protection
MOV for surge protection >4000V passed
1000V Bridge rectifier



Are you still worrying these problem?

Short circuit? Burn out? Poor quality?

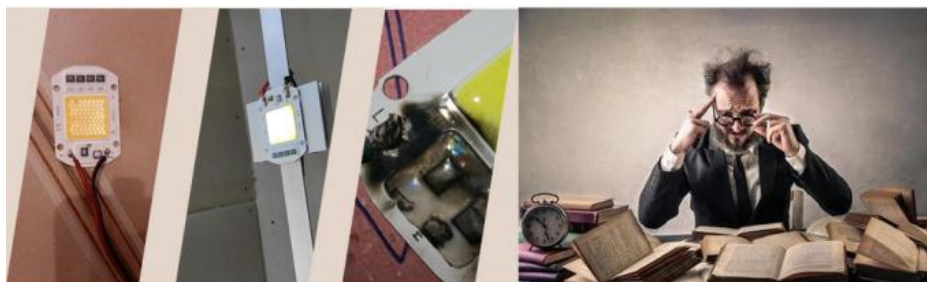

Don't worry !

Newspectrum LED CHIP

CHANGE YOUR LIFE

Full Power High Lumens 4KV Surge Protection Life Guarantee

Why heat dissipation faster?

A3: 1.6mm high thermal conductivity aluminum material



Ours



Others

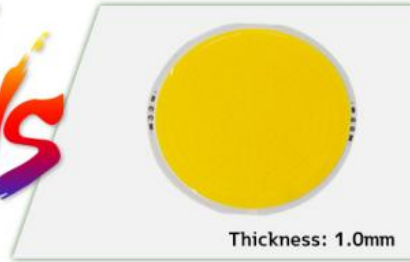

Why is it safer ?

A4: More secure with multiple protections



Chips are bigger than others	(1)	Ordinary chip
Mov for surge protection > 4000V passed	(2)	No
1000V bridge rectifier	(3)	No
Constant current and constant power control	(4)	No
NTC sensor for pcb overheat protection	(5)	No
Can use led dimmer or SCR dimmer to dimming it	(7)	Can't dimming

Two-in-one

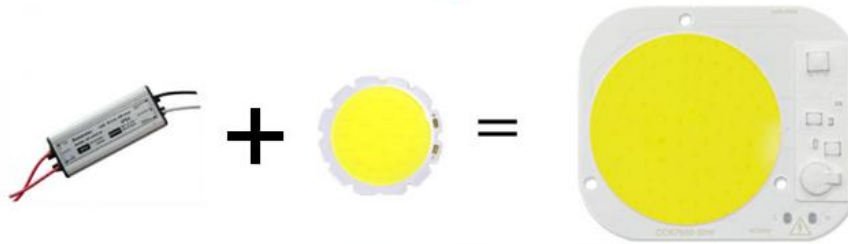

Smart ic no driver

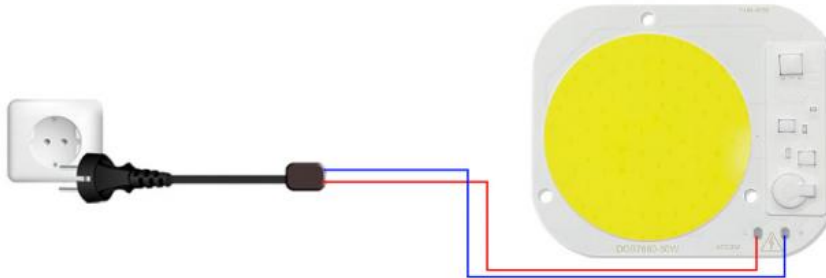

CERTIFICART

Quality Assurance



Why is the quality better ?

A1: There are components that other suppliers don't have



Ours



Others

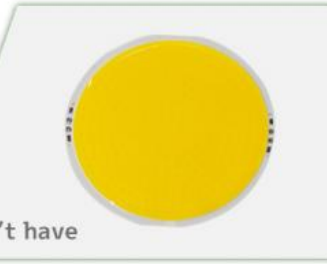

Don't have

Why is it brighter ?

A2: LED chips 3 times bigger than others



Ours



Chips Size 15*30

Others



Chips Size 5*10

Product Details

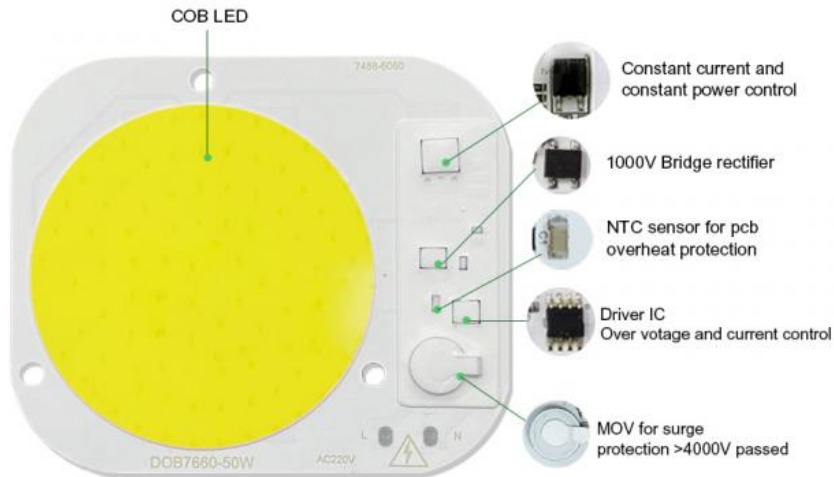

Model	DOB7660-50W	Power	50W
Voltage	AC220-240V(50Hz/60Hz)	CCT	4000-6500K
PF	>0.9	CRI	80
Viewing angle	120°	Luminous	100lm/W
Size	74mm*85mm	Hole diameter	3.5mm
Luminous size	Φ 60mm	Board thickness	1.6mm

CUSTOMIZED

Focus on AC/COB 10 Years



Packing



About us

Colighting company was founded in 2013, We got the certification of national high-tech enterprise from Chinese official department in 2021. We focus on the LED COB and AC LED and SMT Chips production and development. We have own 40 patents and 2000 square meters factory for led chips assembly production line in China. We are making customized led products for many customers.



Welcome to our factory!

VIEW MORE>



Please Leave Us 5 Star Feedback



Item as described ★★★★★

Communication ★★★★★

Shipping Speed ★★★★★



We greatly appreciate your 5-star feedback.

We highly appreciate your reviews as they allow us to offer better services to you. Your satisfaction and positive feedback are very important to our business's development.

If you are not satisfied with your purchase, please contact us before leaving neutral or negative feedback or opening a dispute. We will try our best to solve any problems you may have.

Thank you for your support, enjoy your shopping!



Shenzhen Colighting Ltd



+86-18926589891



bon@colighting.com



cobledchip.com

3rd Floor of building 1, No.5 of Shijing Industrial Park, Pingkui Road, Pingshan district, Shenzhen, China, 518118