

Solderless Cob Driver Led Chip Cold White 30w Led Module For DIY Floodlights

Our Product Introduction

Basic Information

- Place of Origin: Shenzhen China
- Brand Name: newspectrum
- Model Number: NEW 7440
- Minimum Order Quantity: 100pcs
- Price: Negotiable
- Packaging Details: Antistatic bag, boxes in carton.
- Delivery Time: 3-8 work days
- Payment Terms: L/C, D/A, D/P, T/T, Western Union, MoneyGram
- Supply Ability: 100000pcs/day

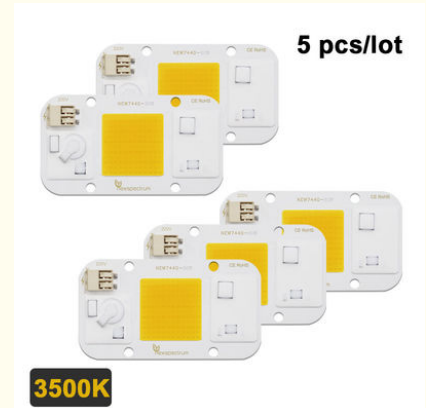

Product Specification

- Voltage (V) : AC 110/220V
- Power (W) : 20W/30W/50W
- CCT: 3000k
- Size (mm) : 40*74*1.6mm
- Product Name: AC LED Module
- Type: COB LED
- Lighting Solutions Service: Lighting And Circuitry Design
- Warranty: 3 Years
- Highlight: Solderless 30w Led Module, DIY Floodlights 30w Led Module, Solderless DOB Led Chip



More Images

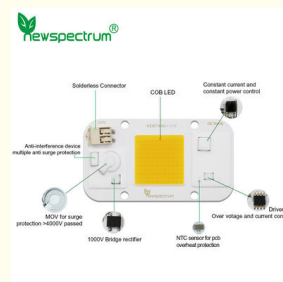
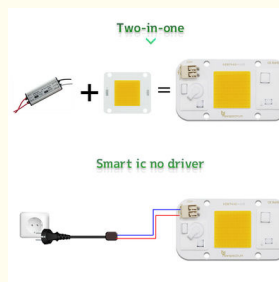

for more products please visit us on cobledchip.com

Product Description

AC110V Solderless COB LED COB Chip 50W Driver Free Cold White Light Beads For Floodlights

5pcs/lot 110V/220V 20W 30W 50W Solderless Driver Free LED Matrix Chip Suitable For DIY Floodlights

Essential details

Color Temperature(CCT):	3000K(Warm White)
Input Voltage(V):	110V/220V
Warranty(Year):	3-Year
Support Dimmer:	NO
Lighting solutions service:	Lighting and circuitry design
Luminous Efficacy(lm/w):	100
Lifespan (hours):	50000
Working Time (hours):	50000
Product Weight(kg):	0.024
Chip Material:	AlGaInP
Emitting Color:	Cold hite
Luminous Intensity:	100
Luminous Flux(lm):	5000
Optical Attenuation(%):	1
Power:	100
Power Dissipation:	0.99
Viewing Angle(°):	120
Color Rendering Index(Ra):	80
Operating Temperature(°C):	-20 - 60
Storage Temperature(°C):	-20 - 60
Place of Origin:	Guangdong, China
Brand Name:	Newspectrum

Product Description

Specification

LED CHIPS

For in floodlight / grow light chip

5 pcs/lot



Are you still worrying these problem?

Short circuit? Burn out? Poor quality?

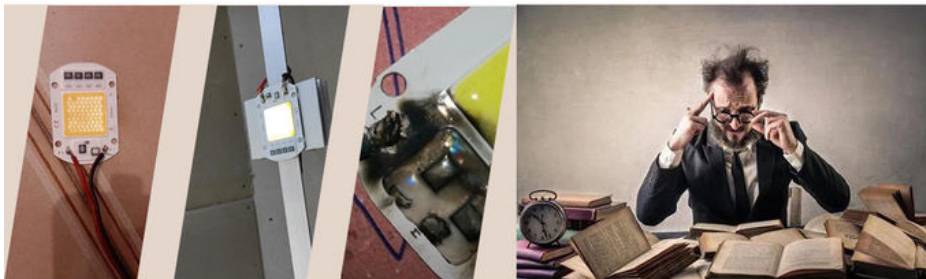

Don't worry !

Newspectrum LED CHIP

BENEFIT YOUR LIFE



Full Power



High Lumens



4KV Surge Protection



Life Guarantee

Solderless Connector

A1 : Solderless connector, safe and convenient



Ours



Others

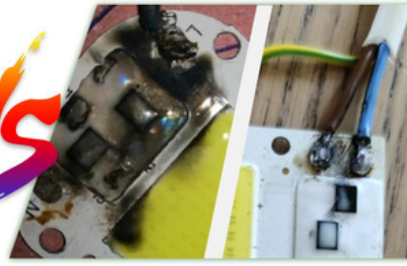

Why is the quality better ?

A2: There are components that other suppliers don't have



Ours



Others



Don't have

Why is it brighter ?

A3: LED chips 3 times bigger than others



Ours



Others

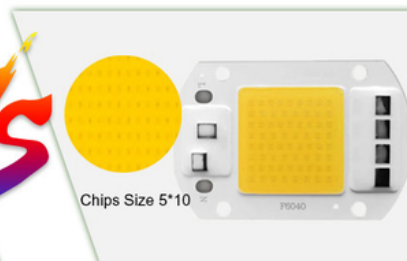

Chips Size 15*30

Chips Size 5*10

Why heat dissipation faster?

A4:1.6mm high thermal conductivity aluminum material



Ours



Thickness: 1.6mm



Others



Thickness: 1.0mm

Why is it safer ?

A5:More secure with multiple protections



Ours



Others

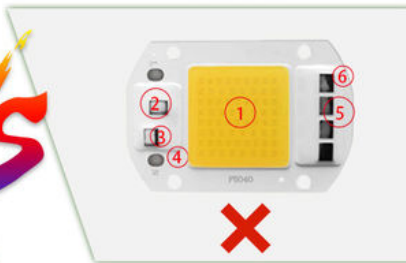

Chips are bigger than others	(1)	Ordinary chip
Solderless Connector	(2)	No
Anti-interference device multiple anti surge protection	(3)	No
Mov for surge protection>4000V passed	(4)	Mov for surge protection<1000V passed
1000V bridge rectifier	(5)	500V bridge rectifier
Constant current and constant power control	(6)	Unstable output power current
Driver IC over voltage and current control	(7)	No
NTC sensor for pcb overheat protection	(8)	No

Product Details

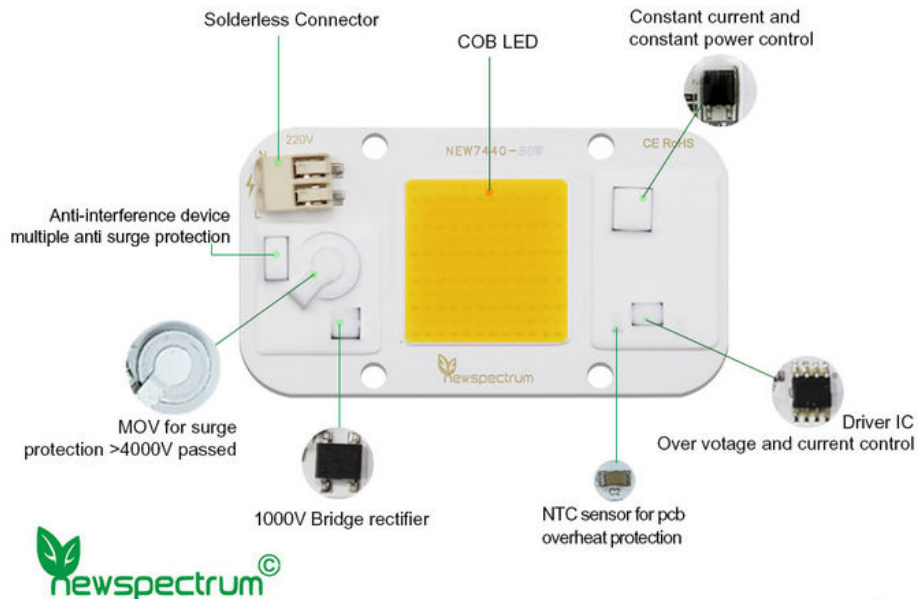

20W/30W/50W

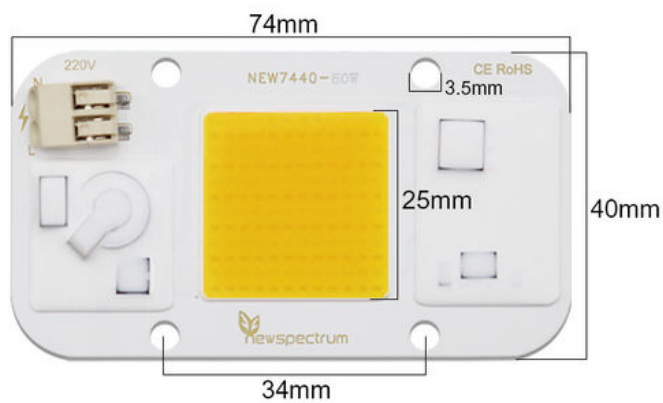

Model	NEW7440-50W	Power	20W/30W/50W
Voltage	AC220V-240V	CCT	3000K
Size	40mm*74mm	CRI	80
Viewing angle	120°	Lumens	100lm/W
Lifespan	50000hrs	Hole diameter	3.5mm
Luminous size	25mm*25mm	Board thickness	1.6mm

● 50W

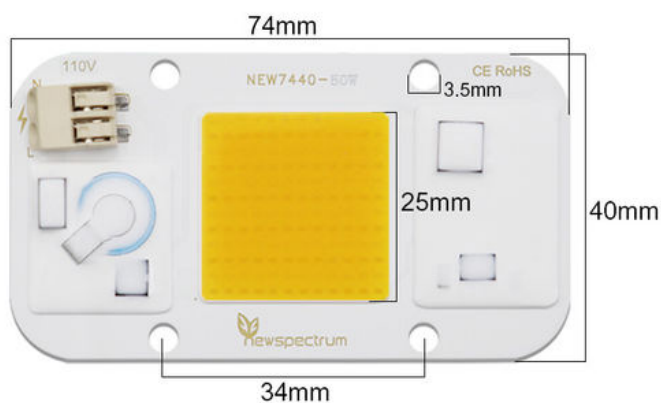

Model	NEWS7440-50W	Power	50W
Voltage	AC110V-130V	CCT	3000K
Size	40mm*74mm	CRI	80
Viewing angle	120°	Lumens	100lm/W
Lifespan	50000hrs	Hole diameter	3.5mm
Luminous size	25mm*25mm	Board thickness	1.6mm

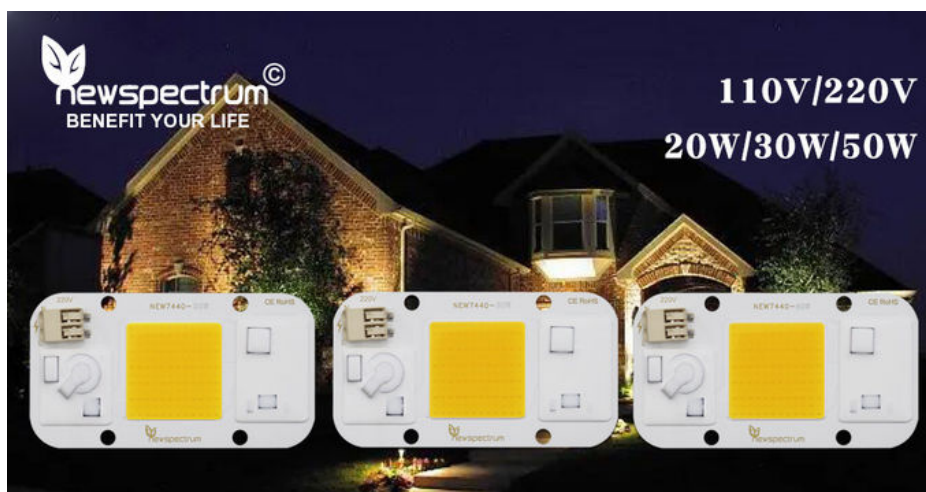

Product Features



Intelligent-control circuit
component safe reliable high quality

High quality light-emitting chip
long service life

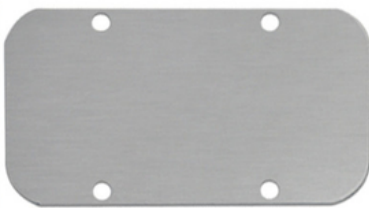

Durable aluminum substrate provide
great heat dissipation effect

Smart IC chip miniaturization
intelligent extend product's lifespan



Two-in-one



Smart ic no driver

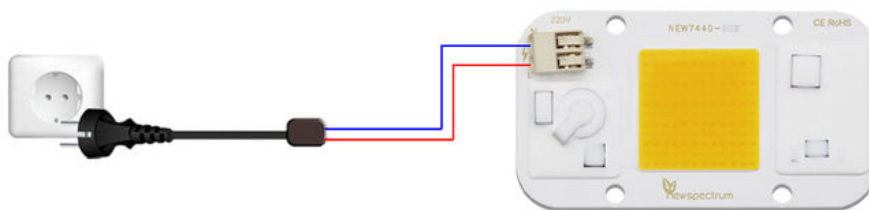

LED Chip with Holder

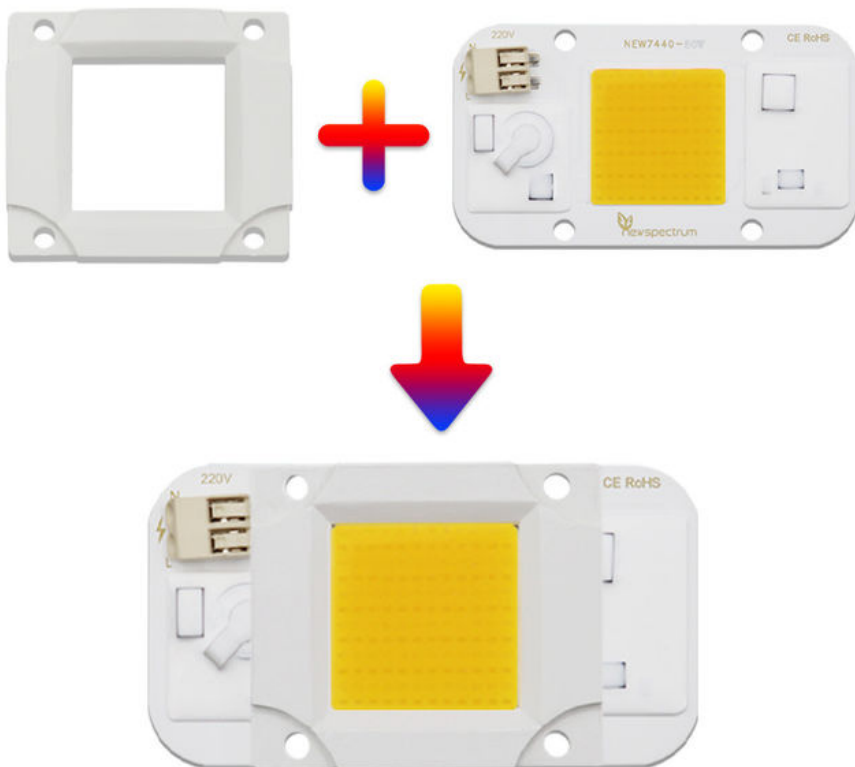





CUSTOMIZED





Focus on AC/COB 10 Years







Nature White Warm White Green Blue



Golden Yellow Amber Pink Red

*Please contact us

● Brightness ● Colour ● LOGO

Packing



CERTIFICART

Quality Assurance



Real Photo

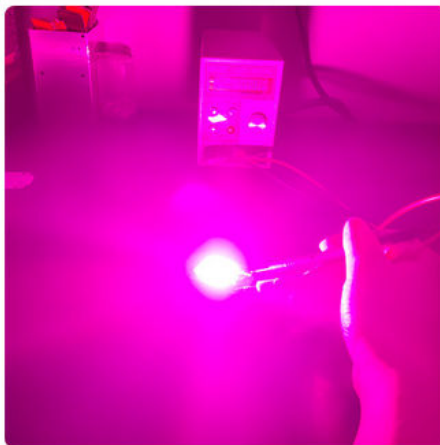
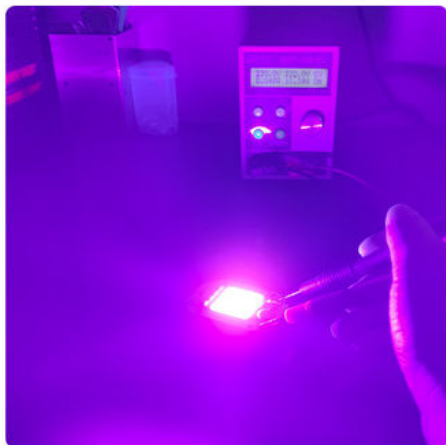

Certificate

Quality Assurance



WHY CHOOSE Newpectrum ?

Really effective plant spectrum



Warm White

The 3500 K spectrum is what plants need

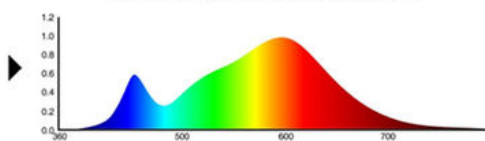

Pink

The wavelength of 660nm is what plants need

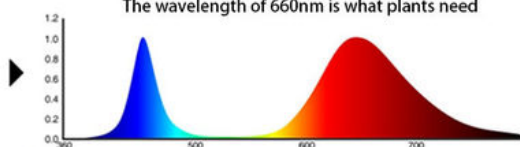

Others



The 630nm wavelength spectrum cannot be fully absorbed by plants

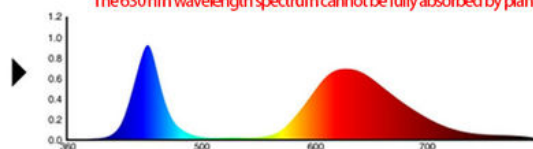

item	value
Color Temperature(CCT)	3000K(Warm White)
Input Voltage(V)	110V/220V
Warranty(Year)	3-Year
Type	COB LED
Support Dimmer	NO
Lighting solutions service	Lighting and circuitry design
Luminous Efficacy(lm/w)	100
Lifespan (hours)	50000
Working Time (hours)	50000
Product Weight(kg)	0.024
Chip Material	AlGaInP
Emitting Color	Warm White
Luminous Intensity	100

Luminous Flux(lm)	5000
Optical Attenuation(%)	1
Power	100
Power Dissipation	0.99
Viewing Angle(°)	120
Color Rendering Index(Ra)	80
Color Temperature	3000K
Operating Temperature(°C)	
Storage Temperature(°C)	
Place of Origin	Guangdong, China
Brand Name	Newspectrum

FAQ

Q1: Can I have a sample order to test?

A: Yes, we are pleased to supply samples to test and check quality, mixed sample order is available.

Q2: Do you have any MOQ limited?

A: Low MOQ, 1 pcs to test is available.

Q3: How long is the lead time?

A: Sample in stock: 1-3 days. Customized production: 7-15 days depend on the order quantity.

Q4: How to order the good?

A: First, tell us your request or application.

Second, according to your requirements, we give you the quotation.

Third, the customer confirms the sample of the official order, the destination of the transportation, and the fee for the payment of the sample.

Fourth, after receiving the payment, we will arrange production and deliver the goods in time.

Packing & Delivery

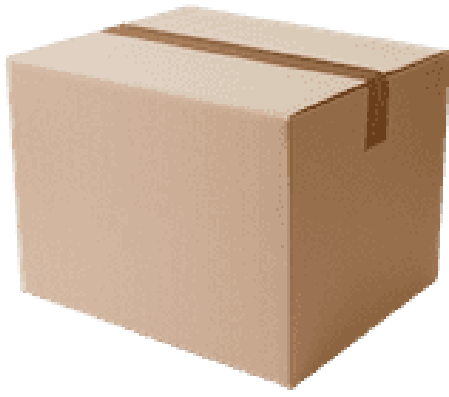

Shenzhen Colighting Ltd



+86-18926589891



bon@colighting.com



cobledchip.com

3rd Floor of building 1, No.5 of Shijing Industrial Park, Pingkui Road, Pingshan district, Shenzhen, China, 518118