

## No Flicker Cob Chip On Board AC 220V 6000K Cob Led Driver Ic

### Our Product Introduction

for more products please visit us on [cobledchip.com](http://cobledchip.com)

#### Basic Information

- Place of Origin: Shenzhen China
- Brand Name: newspectrum
- Model Number: 1235A
- Minimum Order Quantity: 100pcs
- Price: Negotiable
- Packaging Details: Antistatic bag, boxes in carton.
- Delivery Time: 3-5 workdays
- Payment Terms: L/C, D/A, D/P, T/T, Western Union, MoneyGram
- Supply Ability: 100000pcs/day

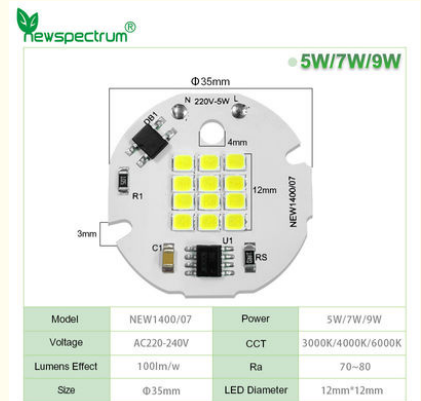

#### Product Specification

- Product Name: SMD LED Chip 12W
- Power: 5W
- CCT: 6000K
- Application: Spotlights/Downlight/Track Light
- Voltage: 220V
- 220V Chip Material: INGAN
- Highlight: No Flicker Cob Chip On Board,  
6000K Cob Chip On Board,  
6000K Dob Led Driver Ic



#### More Images

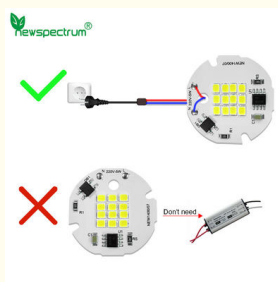
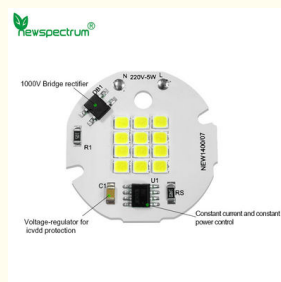

## Product Description

# Driver on board no flicker 5W 100lm/w AC 220V 6000K SMD led chips on Board LED COB IC driver for 5W led bulb board

voltage	220V
Chip material	INGAN
CCT	6000K
power	5W

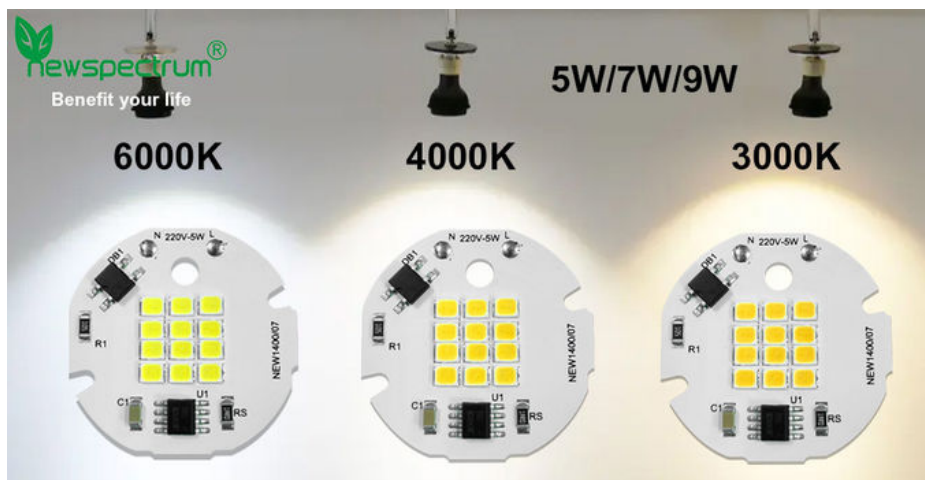

Are you still worrying these problem?

Short circuit? Burn out? Poor quality?

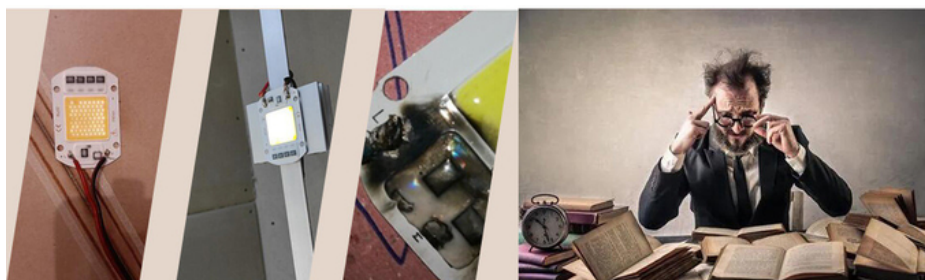

Don't worry !

**Newspectrum LED CHIP**

Benefit your life

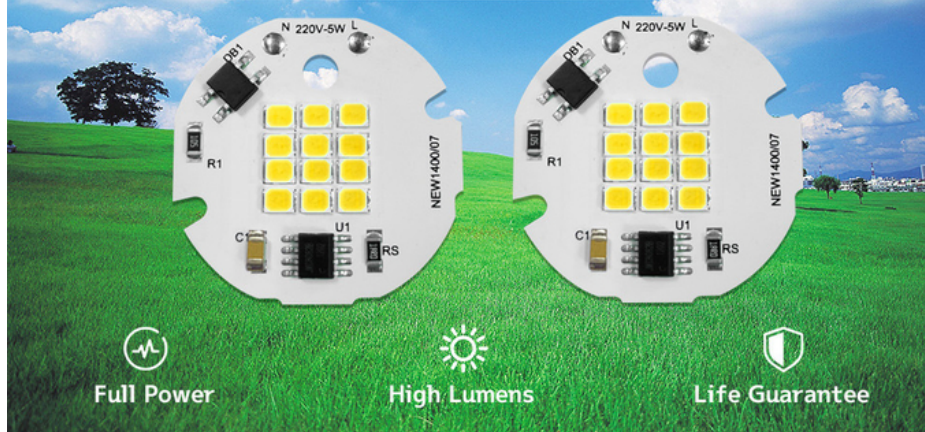

Our Product Introduction

for more products please visit us on [cobledchip.com](http://cobledchip.com)

## Why is it safer ?

A3: More secure with multiple protections

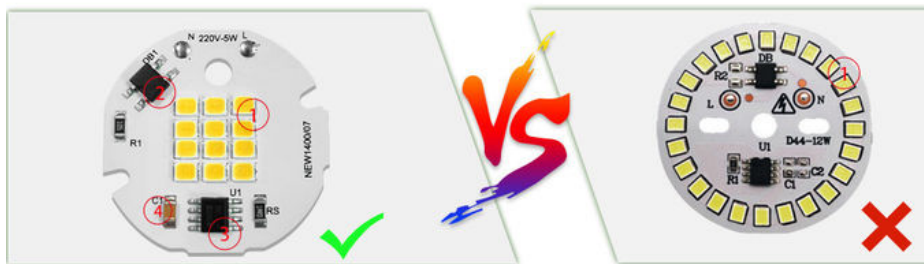

Our chips are brighter than others	(1)	Ordinary chip
1000V bridge rectifier	(2)	No
Constant current and constant power control	(3)	No
Voltage-regulator for icvdd protection	(4)	No

## Product Details



Intelligent-control circuit  
component safe, reliable, high quality

High quality light-emitting chip  
long service life

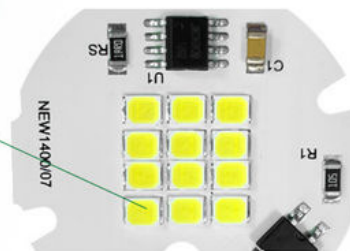

Durable aluminum substrate provide  
great heat dissipation effect

Smart IC chip miniaturization,  
intelligent extend product's lifespan

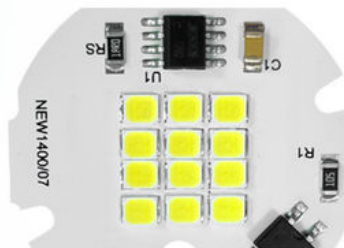



# Smart IC No Driver

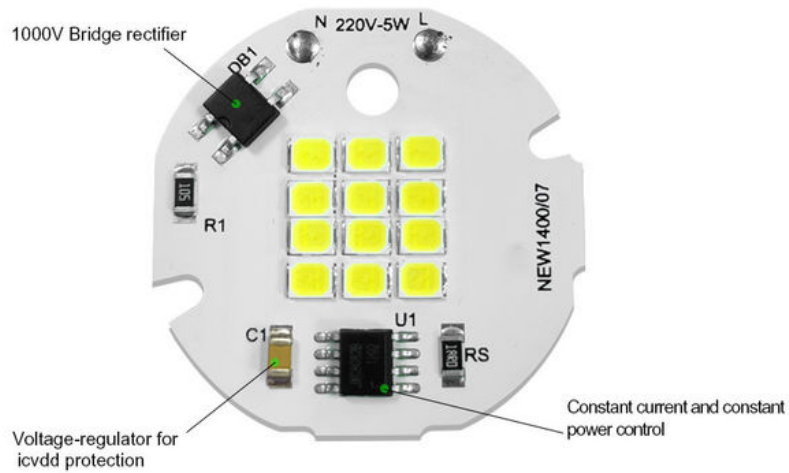
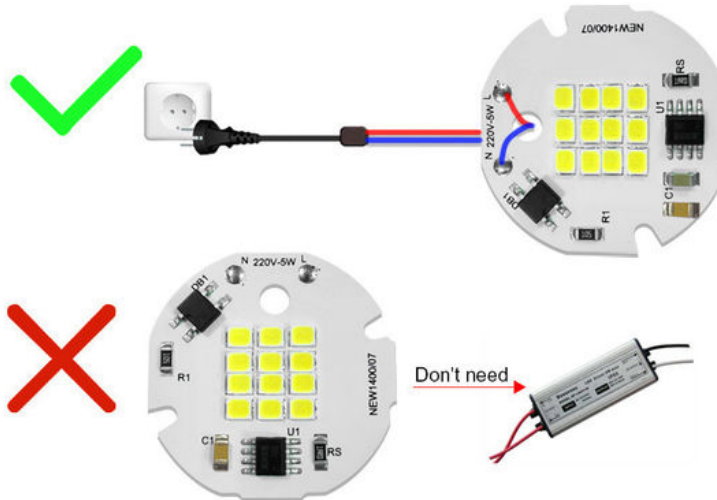

● 5W/7W/9W

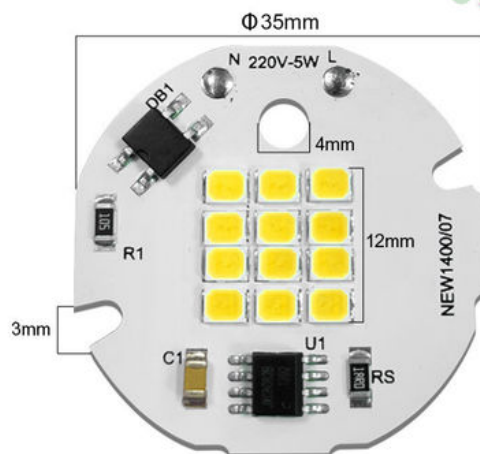

Model	NEW1400/07	Power	5W/7W/9W
Voltage	AC220-240V	CCT	3000K/4000K/6000K
Lumens Effect	100lm/w	Ra	70~80
Size	Φ35mm	LED Diameter	12mm*12mm

## Application scenarios



## FAQ

### Q1: Are you a manufacturer or trading company?

A: Shenzhen Colighting Ltd is a leading LED light source manufacturer founded in 2013 in Shenzhen, China. We have a professional R & D team with more than 18 years experiences in LED industry. We have many patent products with independent innovation. Furthermore, we provide standardization products as well as customization service that already benefited many customers all over the world with "OPTIMAL" quality products at "OPTIMAL" prices.

### Q2: Do you supply OEM & ODM service?

A2: YES, absolutely it can be realized. Colighting focus on OEM & ODM service more than 12 years.

### Q3: All the pictures are real photo?

A3: Yes, the pictures of all products on this page are 100% real shoot by us.

### Q4: Can I have a sample order to test?

A4: Yes, we are pleased to supply samples to test and check quality, mixed sample order is available.

**Q5: What about the lead time?**

A5 : Sample in stock:1-3days. Customized production:7-15days, depends on the order quantity.

**Q6: How can you guarantee the quality?**

A6 : Multiple lighting and aging tests ensure high quality for each product; Professional product quality inspection team ensures that the functions of the product are intact and works stably; If there are still some defective problems, please contact the customer service in time. We will solve your problem at the first time and replace and resend new product for free.

**Q7: How can I place an order?**

A7: First, tell us your request or application. Second, according to your requirements, we give you the quotation. Third, the customer confirms the sample of the official order, the destination of the transportation, and pay for the payment of the sample. Fourth, after receiving the payment, we will arrange production and deliver the goods in time.



**Shenzhen Colighting Ltd**



+86-18926589891



bon@colighting.com



cobledchip.com

3rd Floor of building 1, No.5 of Shijing Industrial Park, Pingkui Road, Pingshan district, Shenzhen, China, 518118