

3000lm COB LED Module COB Chip 50Watt 6000K For Commercial Lighting Solutions

Our Product Introduction

Basic Information

- Place of Origin: Shenzhen China
- Brand Name: newspectrum
- Model Number: DOB2975
- Minimum Order Quantity: 100pcs
- Price: Negotiable
- Packaging Details: Antistatic bag, boxes in carton.
- Delivery Time: 3-5 workdays
- Payment Terms: L/C, D/A, D/P, T/T, Western Union, MoneyGram
- Supply Ability: 100000pcs/day

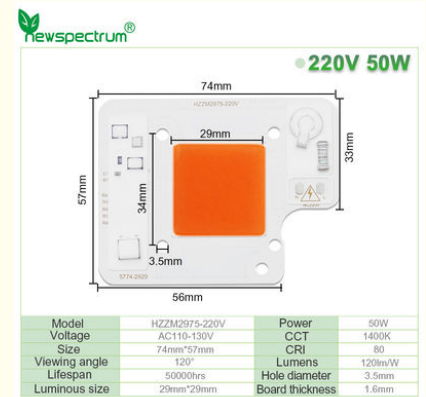

Product Specification

- Warranty: 3 Years
- Product Name: COB LED Module
- Model: DOB2975
- IP Grade: IP65
- Color Temperature: 3000K/4000K/6000K
- Voltage: AC220-240V
- CCT: 1400K
- Material: Aluminum
- Highlight: 50 Watt DOB LED Module, 50 Watt LED COB Chip

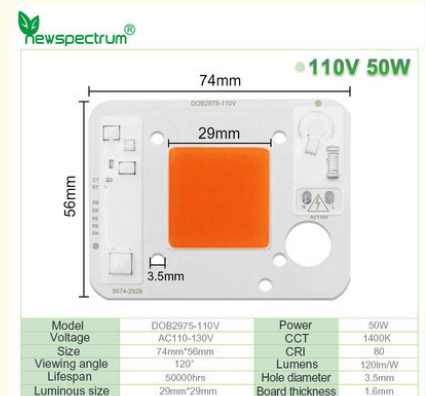

More Images

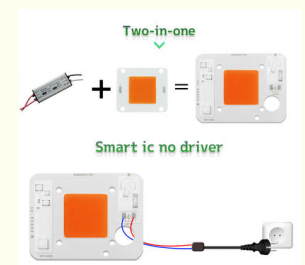
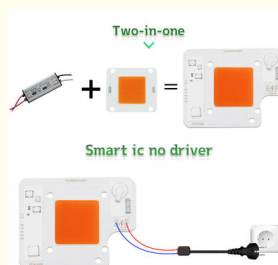
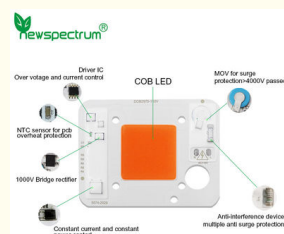

for more products please visit us on cobledchip.com

Product Description

Product Description:

3000lm COB LED Module For Commercial Lighting Solutions

COB LED Module is a 50-watt LED COB chip with a wide range of color temperatures from 1400K to 6000K. It is designed with an aluminum material for superior durability and is IP65 rated for water and dust resistance. The COB LED type offers a uniform light source with excellent color rendering, along with a long lifespan and low energy consumption. With its superior optical performance and high efficiency, the COB LED Module provides a perfect solution for lighting applications.

Features:

Product Name: COB LED Module

Material: Aluminum

Full Spectrum Cob Led: COB LED Chip

Color Temperature: 3000K/4000K/6000K

Warm White Led Module: 50,000 Hours Lifespan

Beam Angle: 120°

CRI: Ra>80

Product Details

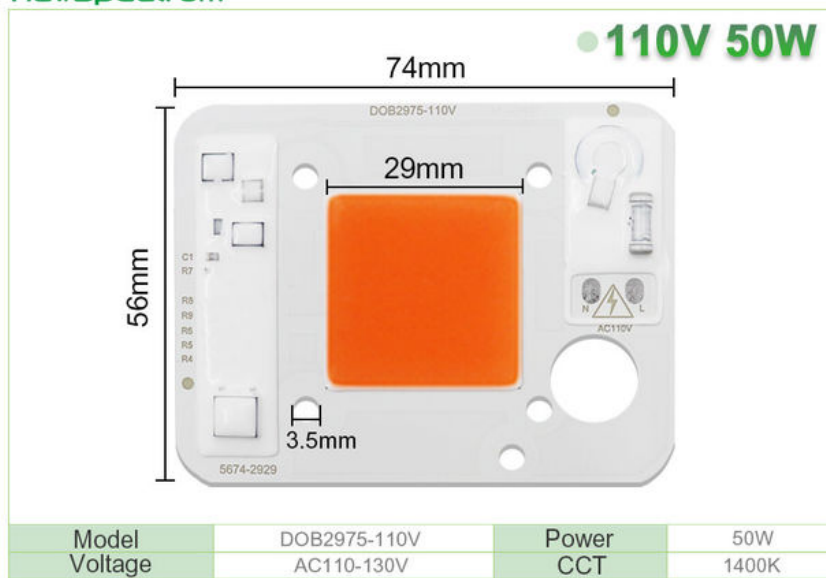
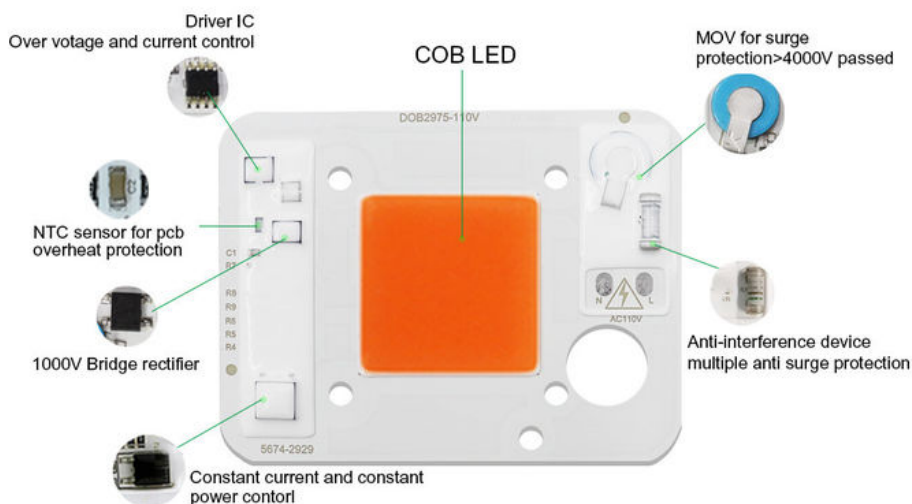

Size	74mm*56mm	CRI	80
Viewing angle	120°	Lumens	120lm/W
Lifespan	50000hrs	Hole diameter	3.5mm
Luminous size	29mm*29mm	Board thickness	1.6mm



● 220V 50W

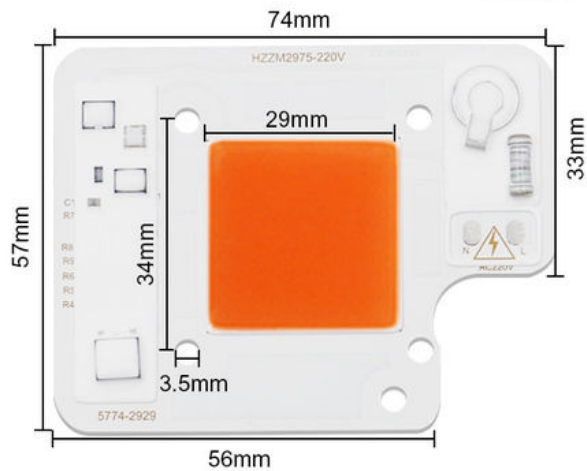

Model	HZZM2975-220V	Power	50W
Voltage	AC220-240V	CCT	1400K
Size	74mm*57mm	CRI	80
Viewing angle	120°	Lumens	120lm/W
Lifespan	50000hrs	Hole diameter	3.5mm
Luminous size	29mm*29mm	Board thickness	1.6mm

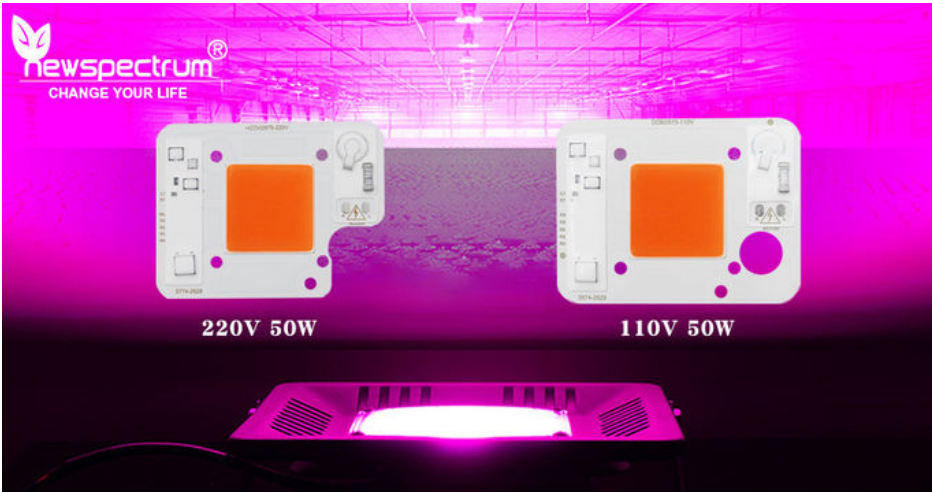

Application scenarios



CUSTOMIZED

Focus on AC/COB **10** Years





*Please contact us

● Brightness ● Colour ● LOGO



Nature White



Warm White



Green



Blue



Golden Yellow



Amber



Pink



Red

Packing







1



2



3



4

Two-in-one

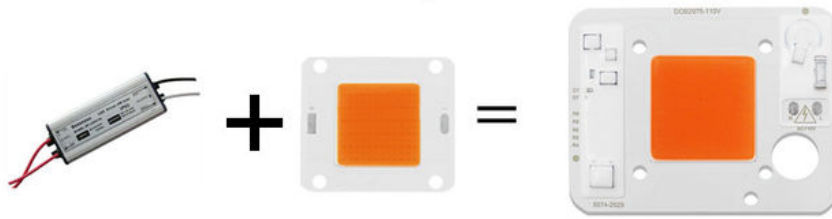

Smart ic no driver

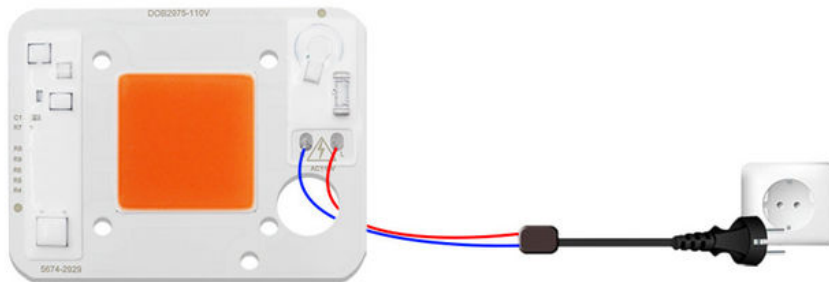

CERTIFICART

Quality Assurance



Are you still worrying these problem?

Short circuit? Burn out? Poor quality?

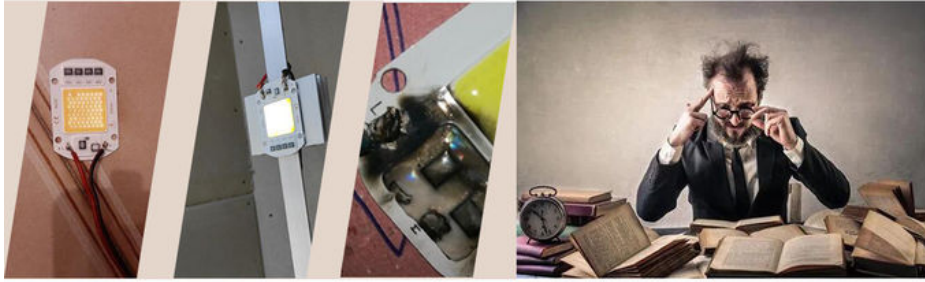

Don't worry !
Newspectrum LED CHIP
CHANGE YOUR LIFE

Full Power High Lumens 4KV Surge Protection Life Guarantee

Technical Parameters:

Attribute	Value
Warranty	3 Years
IP Grade	IP65
Power	50W
Model	DOB2975
CCT	1400K
LED Type	COB
Full Spectrum Cob Led	50w Led Cob Chip, 20W Chip LED
Color Temperature	3000K/4000K/6000K
Voltage	AC220-240V
Lifespan	50,000 Hours
Size	74*57*1.6mm

Applications:

COB LED Module is a perfect choice for lighting applications, offering warm white full spectrum lighting with a 50W chip LED. It is designed with IP65 waterproof grade, and the robust aluminum body ensures durability and long-term use. The beam angle of 120° ensures wide coverage, while the AC220-240V voltage makes it suitable for a variety of locations. The COB LED type provides high-quality lighting and superior performance, making it an ideal choice for both residential and commercial applications.

Customization:

Customized COB LED Module

Brand Name: COB LED Module
Place of Origin: Shenzhen China
LED Type: COB
CCT: 1400K
Warranty: 3 Years
Model: DOB2975

Our COB LED Module offers full spectrum cob led for warm white lighting. It is a perfect solution for a variety of lighting applications. This module is made of high-quality COB LED with a CCT of 1400K. It is 74*57*1.6mm in size and comes with a 3-year warranty. Get your customized COB LED Module now!

FAQ:

Q1: What is newspectrum?

A1: newspectrum is a brand of LED modules manufacturer in Shenzhen, China.

Q2: What is the advantage of COB LED Module?

A2: COB LED Module has a wide range of advantages, including high brightness, good heat dissipation, long life, low power consumption, and low cost.

Q3: What is the application of COB LED Module?

A3: COB LED Module can be widely used in indoor and outdoor lighting, such as landscape lighting, stage lighting, street lighting, and so on.

Q4: What is the warranty for COB LED Module?

A4: COB LED Module provides a warranty of up to 3 years for quality assurance.

Q5: How to install COB LED Module?

A5: COB LED Module is easy to install, it can be installed quickly and easily with no professional experience required.



Shenzhen Colighting Ltd



+86-18926589891



bon@colighting.com



cobledchip.com

3rd Floor of building 1, No.5 of Shijing Industrial Park, Pingkui Road, Pingshan district, Shenzhen, China, 518118